



U.S. Department of Transportation
**Federal Highway
Administration**



KEEPMOVING550.COM

NOTE: All work is scheduled weather permitting, and is subject to change without notice.

IMPORTANT Construction Update:
Construction to Shift from South Side
of U.S. 550 to North Side
Friday, June 5, 2020

REGULAR WORK HOURS: Monday-Friday 7 a.m.-5 p.m.

NEW: As of Friday, June 5, 2020, construction will shift from the south side of U.S. 550 to to the north side of U.S. 550 between NM 313 (Camino del Pueblo) and the Rio Grande Bridge.

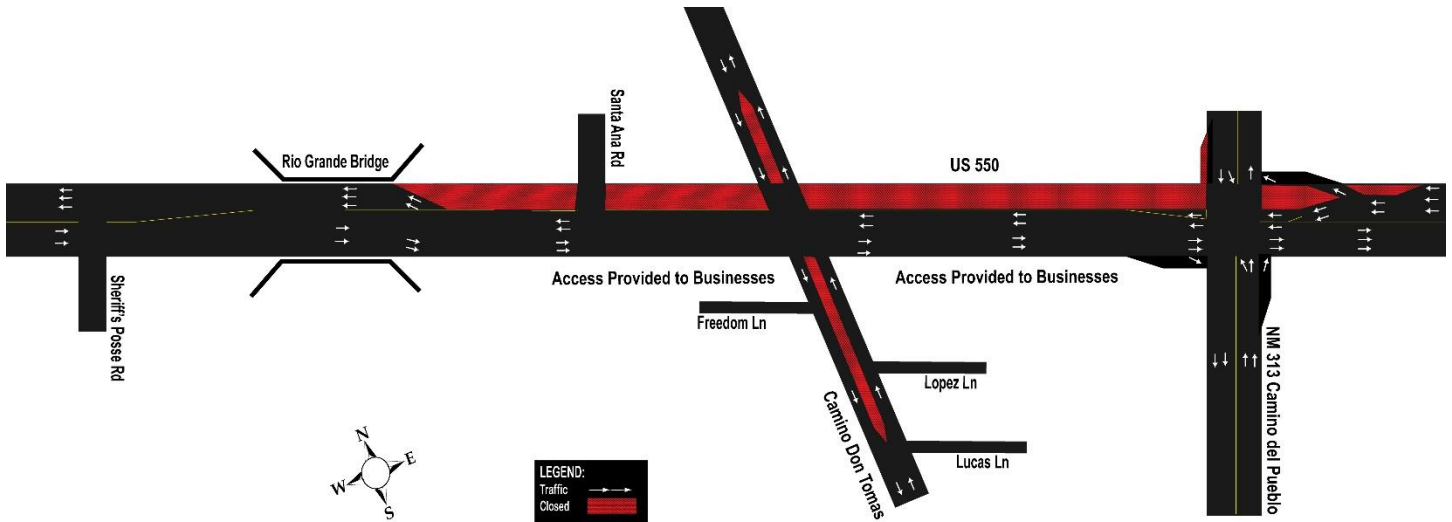

Camino Don Tomas will reopen with one lane of traffic in each direction (north and south) north and south of U.S. 550 while crews perform work in the medians. There will be no restrictions at U.S. 550 and Don Tomas.

The construction zone will be on the north side of U.S. 550, separated by a concrete wall barrier. **PLEASE DO NOT DRIVE BEHIND THE CONCRETE WALL BARRIER.** There will be two travel lanes in each direction (east and west) on U.S. 550 but there will be **no center left turn lane. Left turns will only be permitted at signalized intersections (NM 313, Camino Don Tomas, etc.) ACCESS IS PROVIDED TO BUSINESSES ON THE NORTH SIDE OF U.S. 550 VIA SELECTED DRIVEWAYS.**

MOTORISTS ARE ENCOURAGED TO EXPECT DELAYS AND TO GIVE THEMSELVES EXTRA TIME TO REACH THEIR DESTINATIONS.

FOLLOW THESE RULES IN THE CONSTRUCTION ZONE TO AVOID A TICKET!

1. Do **not** speed. Obey lower posted speed limits. Speeding fines are doubled in the construction zone.
2. Do **not** block intersections.
3. Do **not** turn left across a double yellow line. Left turns are **ONLY** allowed at intersections with traffic signals.

Questions, Concerns: Visit www.keepmoving550.com or www.nmroads.com or contact Patti Watson – 505-245-3134, 505-269-9691, pattiw@cwstrategic.com.