



U.S. Department of Transportation  
**Federal Highway  
Administration**



## Construction Update: Week of July 13-19, 2020

*NOTE: All work is scheduled weather permitting, and is subject to change without notice.*

**REGULAR WORK HOURS:** Monday-Friday 7 a.m.-5 p.m. although crews may work longer hours or weekends if needed. **Crews are scheduled to work Monday, July 13, from 9 p.m.-5 a.m. to install a casing on the new water line. No additional traffic impacts are anticipated.**

**CONTINUING:** Between NM 313 (Camino Del Pueblo) and the Rio Grande Bridge on the north side of U.S. 550, crews are installing concrete drop inlets, SDCP (Silenced De-Cat Pipe), connecting individual services and meters to the new water line, preparing subgrade for eventual paving, installing retaining walls and backfilling around them, and grouting storm drainage connections.

The construction zone is on the north side of U.S. 550 and is separated by concrete wall barrier.

**PLEASE  
DO NOT  
DRIVE  
BEHIND**

**THE CONCRETE WALL BARRIER. ACCESS IS PROVIDED TO BUSINESSES ON THE NORTH SIDE OF U.S. 550 VIA SELECTED DRIVEWAYS.**

Two travel lanes in each direction (east and west) are provided on U.S. 550 and there is **no center left turn lane. Left turns are only permitted at signalized intersections (NM 313, Camino Don Tomas etc.)** Camino Don Tomas is open with one lane of traffic in each direction (north and south) north and south of U.S. 550. There are no restrictions at U.S. 550 and Camino Don Tomas.

**MOTORISTS ARE ENCOURAGED TO EXPECT DELAYS AND TO GIVE THEMSELVES EXTRA TIME TO REACH THEIR DESTINATIONS.**

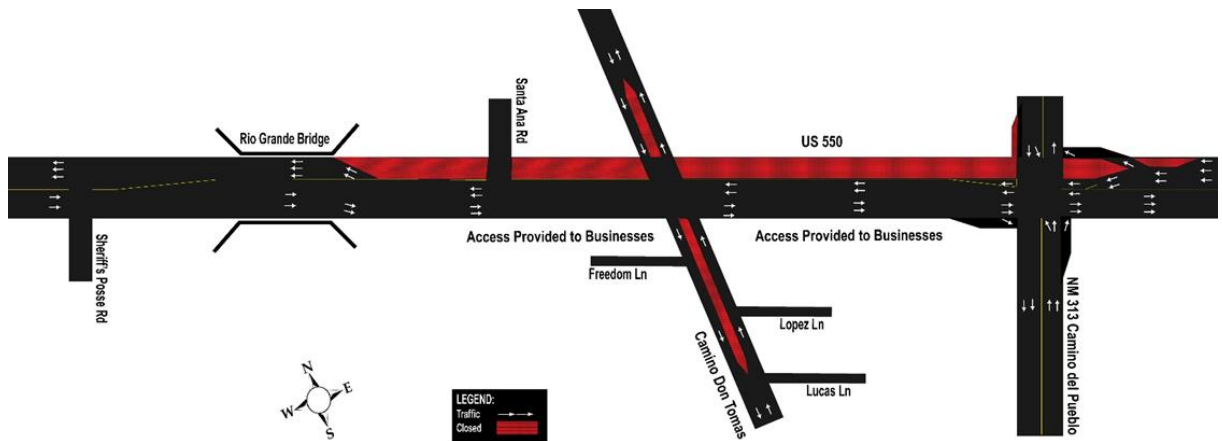

### FOLLOW THESE RULES IN THE CONSTRUCTION ZONE TO AVOID A TICKET!

1. Do not speed. Obey lower posted speed limits. Speeding fines are doubled in the construction zone.
2. Do not block intersections.
3. Do not turn left across a double yellow line. Left turns are ONLY allowed at intersections with traffic signals.

Questions, Concerns: Visit [www.KeepMoving550.com](http://www.KeepMoving550.com) or [www.nmroads.com](http://www.nmroads.com) or contact Patti Watson – 505-245-3134, 505-269-9691, [pattiw@cwstrategic.com](mailto:pattiw@cwstrategic.com).