



U.S. Department of Transportation
**Federal Highway
Administration**



Construction Update: Week of Aug. 24-30, 2020

NOTE: All work is scheduled weather permitting, and is subject to change without notice.

REGULAR WORK HOURS: Monday-Friday 7 a.m.-5 p.m. although crews may work longer hours or weekends if needed.

CONTINUING: Between NM 313 (Camino Del Pueblo) and the Rio Grande Bridge on the north side of U.S. 550, crews are preparing and paving the new roadway. Between NM 313 and Santa Ana Road, crews are pouring concrete driveways, aprons, turnouts and sidewalks.

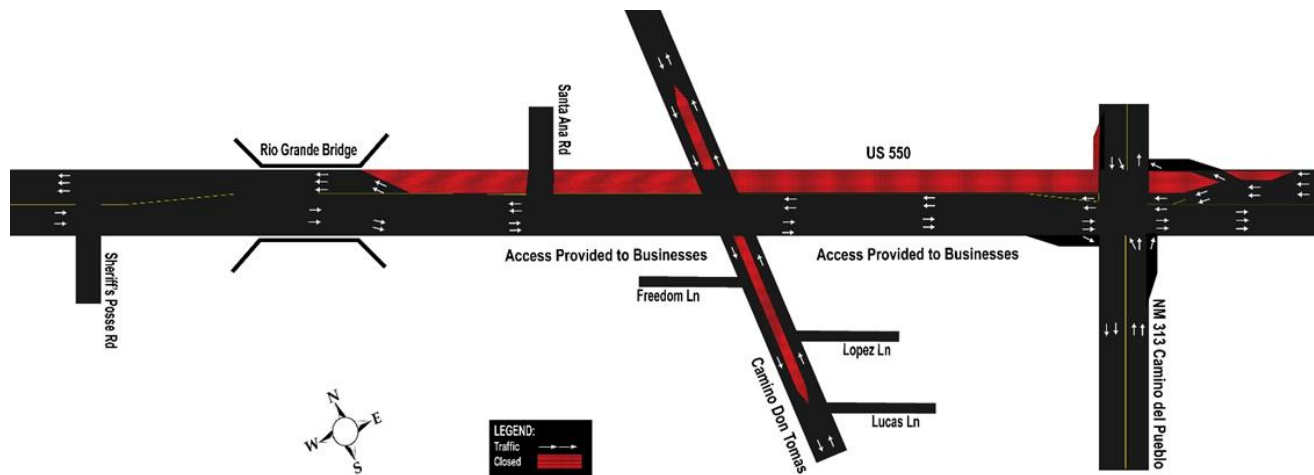

The construction zone is on the north side of U.S. 550 and is separated by concrete wall barrier. **PLEASE DO NOT DRIVE BEHIND THE CONCRETE WALL BARRIER. ACCESS IS PROVIDED TO BUSINESSES ON THE NORTH SIDE OF U.S. 550 VIA SELECTED DRIVEWAYS.**

Two travel lanes in each direction (east and west) are provided on U.S. 550 and there is **no center left turn lane. Left turns are only permitted at signalized intersections (NM 313, Camino Don Tomas etc.) Camino Don Tomas is open with one lane of traffic in each direction (north and south) north and south of U.S. 550.** There are no restrictions at U.S. 550 and Camino Don Tomas.

MOTORISTS ARE ENCOURAGED TO EXPECT DELAYS AND TO GIVE THEMSELVES EXTRA TIME TO REACH THEIR DESTINATIONS.

FOLLOW THESE RULES IN THE CONSTRUCTION ZONE TO AVOID A TICKET!

1. Do not speed. Obey lower posted speed limits. Speeding fines are doubled in the construction zone.
2. Do not block intersections.
3. Do not turn left across a double yellow line. Left turns are ONLY allowed at intersections with traffic signals.

Questions, Concerns: Visit www.keepmoving550.com or www.nmroads.com or contact Patti Watson – 505-245-3134, 505-269-9691, pattiw@cwstrategic.com.