



U.S. Department of Transportation
**Federal Highway
Administration**



Construction Update:
Week of Sept. 14-20, 2020

NOTE: All work is scheduled weather permitting, and is subject to change without notice.

REGULAR WORK HOURS: Monday-Friday 7 a.m.-5 p.m. although crews may work longer hours or weekends if needed.

CONTINUING: Crews are working in the center median area of U.S. 550 between NM 313 (Camino del Pueblo) and the Rio Grande bridge to install manholes and storm drainage pipe. Two lanes of traffic are open in each direction on U.S. 550 (east and west). *NOTE: There may be an arrow truck protecting work in the mornings on the outside lane of westbound U.S. 550 (on the north side of the roadway) to place concrete drive pads, aprons, turnouts and sidewalks. Access is maintained to businesses on the north side of the roadway from selected driveways*

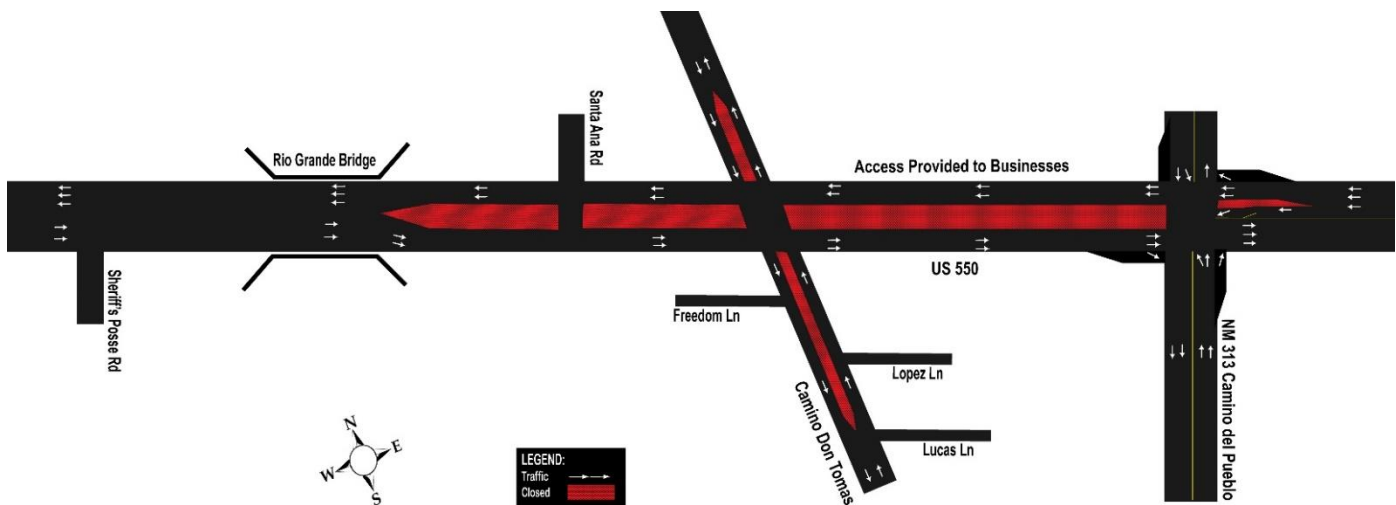

Barricades are expected to remain in the center of the roadway to protect ongoing work for the next several weeks. **Left turns are not permitted, except at signalized intersections (NM 313, Camino Don Tomas etc.)** Camino Don Tomas is open with one lane of traffic in each direction (north and south) north and south of U.S. 550.

MOTORISTS ARE ENCOURAGED TO EXPECT DELAYS AND TO GIVE THEMSELVES EXTRA TIME TO REACH THEIR DESTINATIONS.

FOLLOW THESE RULES IN THE CONSTRUCTION ZONE TO AVOID A TICKET!

1. Do not speed. Obey lower posted speed limits. Speeding fines are doubled in the construction zone.
2. Do not block intersections.
3. Do not turn left across a double yellow line. Left turns are ONLY allowed at intersections with traffic signals.

Questions, Concerns: Visit www.KeepMoving550.com or www.nmroads.com or contact Patti Watson – 505-245-3134, 505-269-9691, pattiw@cwstrategic.com.