



U.S. Department of Transportation
**Federal Highway
Administration**



Construction Update: Week of Sept. 21-27, 2020

NOTE: All work is scheduled weather permitting, and is subject to change without notice.

REGULAR WORK HOURS: Monday-Friday 7 a.m.-5 p.m. although crews may work longer hours or weekends if needed.

NEW: Beginning Tuesday, Sept. 22 and lasting for about 10 days, through about Friday, Oct. 2, 2020, **Camino Don Tomas will be right-in and right-out only** so crews can install a 60-inch storm drain pipe and new manholes. **No left turns in or out of Camino Don Tomas and no thru lanes will be open.**

- **Traffic heading north on Camino Don Tomas south of U.S. 550 will ONLY be able to turn right and head east on U.S. 550.** Traffic will NOT be allowed to cross U.S. 550 or turn left.
- **Traffic heading south on Camino Don Tomas north of U.S. 550 will ONLY be able to turn right and head west on U.S. 550.** Traffic will NOT be allowed to cross U.S. 550 or turn left.
- **Traffic heading west on U.S. 550 will not be able make a left turn to access Camino Don Tomas to the south,** but will be able to turn right to access Camino Don Tomas to head north.
- **Traffic heading east on U.S. 550 will not be able to turn left to access Camino Don Tomas to the north,** but will be able to turn right and access Camino Don Tomas to head south.

CONTINUING: Crews are working in the center median area of U.S. 550 between NM 313 (Camino del Pueblo) and the Rio Grande bridge to install manholes and storm drainage pipe, as well as mill out existing asphalt and add subgrade for eventual repaving.

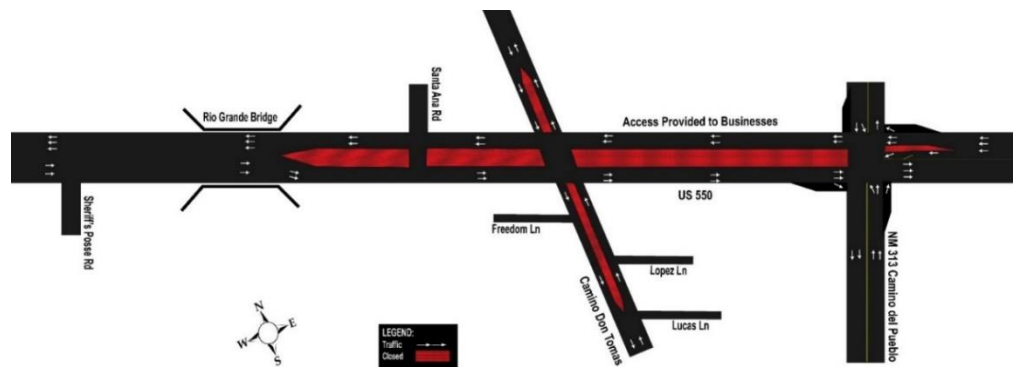

Two lanes of traffic are open in each direction on U.S. 550 (east and west). *NOTE: There may be an arrow truck protecting work in the mornings on the outside lane of westbound U.S. 550 (on the north side of the roadway) to place concrete drive pads, aprons, turnouts and sidewalks. Access is maintained to businesses on the north side of the roadway from selected driveways*

MOTORISTS ARE ENCOURAGED TO EXPECT DELAYS AND TO GIVE THEMSELVES EXTRA TIME TO REACH THEIR DESTINATIONS.

Questions, Concerns: Visit www.KeepMoving550.com or www.nmroads.com or contact Patti Watson – 505-245-3134, 505-269-9691, pattiw@cwastateqic.com.