



## Construction Update: Week of Oct. 12-18, 2020

*NOTE: All work is scheduled weather permitting, and is subject to change without notice.*

**REGULAR WORK HOURS:** Monday-Friday 7 a.m.-5 p.m. although crews may work longer hours or weekends if needed.

**NEW:** Beginning Monday morning, Oct. 12, 2020 and lasting for about two weeks, through about Monday, Oct. 26, 2020, eastbound traffic will be shifted to the north for installation of a 60-inch storm drain pipe on the south side of U.S 550.

Access to some businesses, including the Speedway, Guang Dong Chinese Restaurant, Pharmacy Plus, Wash-Tub Laundromat and Sonic Drive- In will be from the small private road and Freedom Lane via Camino Don Tomas south of U.S. 550 during this work. Custom business access signage will be installed to help guide travelers to these destinations. We recognize this is a major inconvenience and will work with the contractor to complete installation of the storm drain pipe as quickly as possible.

Work on this phase of construction (U.S. 550 east of the Rio Grande Bridge) is nearing completion, with crews expected to move to the phase west of the Rio Grande Bridge on or before December 1, 2020.

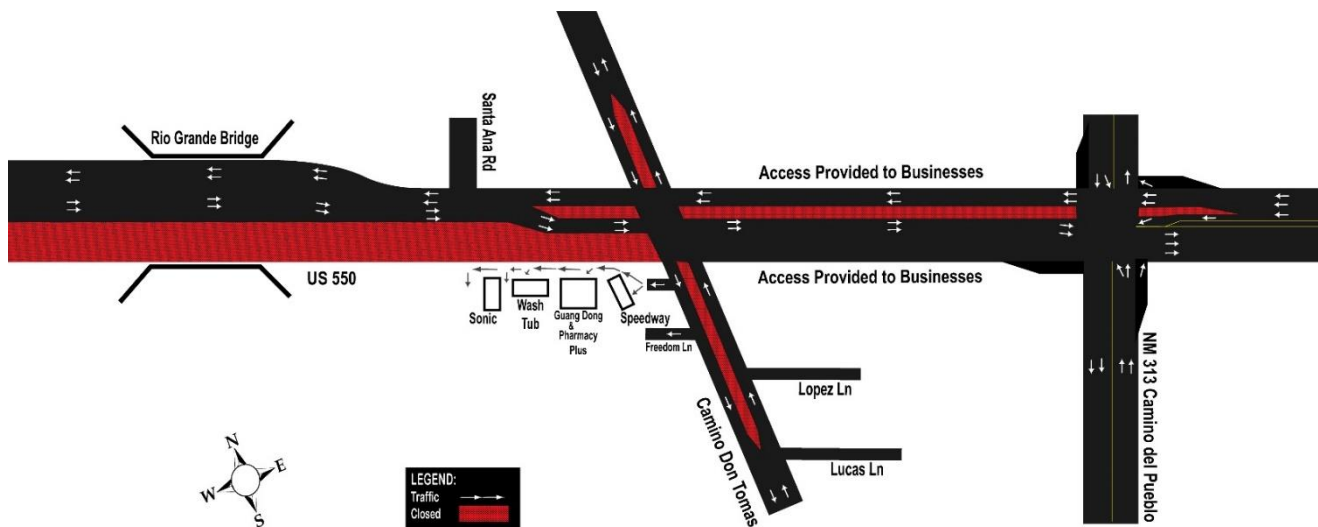

Two travel lanes in each direction (east and west) are provided on U.S. 550 and there is **no center left turn lane**. **Left turns are only permitted at signalized intersections (NM 313, Camino Don Tomas etc.).** Camino Don Tomas is open with one lane of traffic in each direction (north and south) north and south of U.S. 550.

**MOTORISTS ARE ENCOURAGED TO EXPECT DELAYS AND TO GIVE THEMSELVES EXTRA TIME TO REACH THEIR DESTINATIONS.**

Questions, Concerns: Visit [www.KeepMoving550.com](http://www.KeepMoving550.com) or [www.nmroads.com](http://www.nmroads.com) or contact Patti Watson – 505-245-3134, 505-269-9691, [pattiw@cwstrategic.com](mailto:pattiw@cwstrategic.com).