



U.S. Department of Transportation
**Federal Highway
 Administration**



**Construction Update:
 Week of Oct. 19-25, 2020**

NOTE: All work is scheduled weather permitting, and is subject to change without notice.

REGULAR WORK HOURS: Monday-Friday 7 a.m.-5 p.m. although crews may work longer hours or weekends if needed. **Crews are scheduled to place manholes from 9pm-5am Monday-Friday of this week.**

EXTENDED: Due to the amount of work required, eastbound traffic will continue to be shifted to the north for the installation of a 60-inch storm drain pipe and other improvements on the south side of U.S. 550 through about **November 9, 2020**. Access to some businesses, including the Speedway, Guang Dong Chinese Restaurant, Pharmacy Plus, Wash-Tub Laundromat and Sonic Drive-In will be from the small private road and Freedom Lane via Camino Don Tomas south of U.S. 550 during this work. Custom business access signage has been installed to help guide travelers to these destinations.

CONTINUING: Crews are installing curb and gutter on U.S. 550 from NM 313 (Camino Del Pueblo) to the detour on the south side of U.S. 550 and from Camino Don Tomas heading south. They are also back filling areas around manholes, fine grading medians and installing aggregate base course in the construction zone.

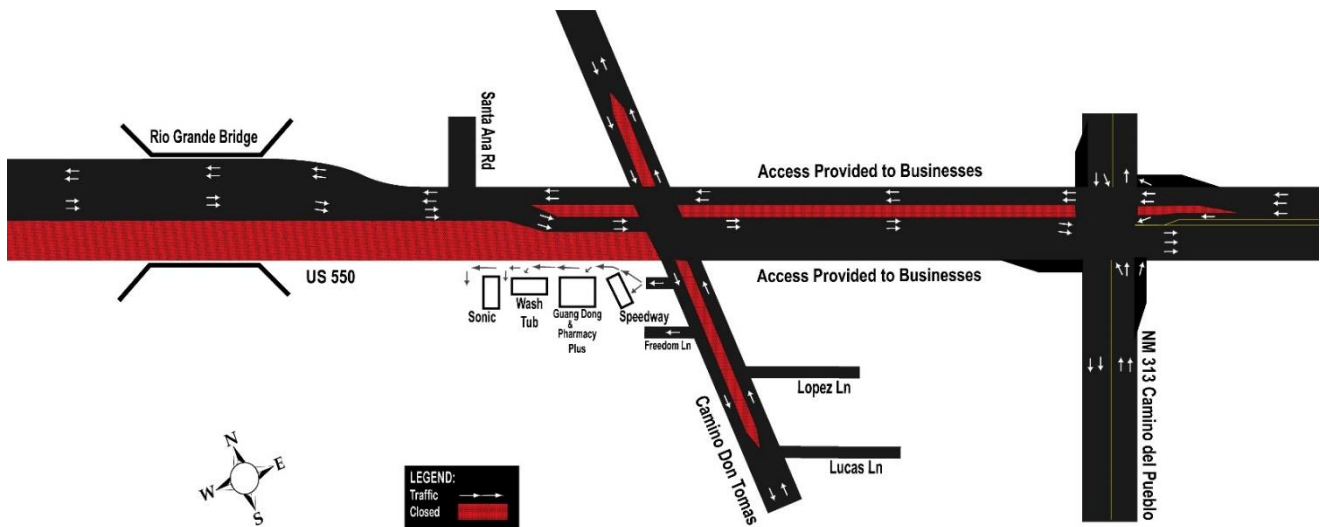

Two travel lanes in each direction (east and west) are provided on U.S. 550 and there is **no center left turn lane**. **Left turns are only permitted at signalized intersections (NM 313, Camino Don Tomas etc.)**. Camino Don Tomas is open with one lane of traffic in each direction (north and south) north and south of U.S. 550.

MOTORISTS ARE ENCOURAGED TO EXPECT DELAYS AND TO GIVE THEMSELVES EXTRA TIME TO REACH THEIR DESTINATIONS.

Questions, Concerns: Visit www.KeepMoving550.com or www.nmroads.com or contact Patti Watson – 505-245-3134, 505-269-9691, pattiw@cwstrategic.com.