



U.S. Department of Transportation
**Federal Highway
Administration**



**Construction Update:
New Lane Closures Scheduled for U.S. 550
Today Through Friday; Ongoing Lane
Closures on NM 528**

NOTE: All work is scheduled weather permitting, and is subject to change without notice.

REGULAR WORK HOURS: Monday-Friday 7 a.m.-5 p.m. although crews may work longer hours or weekends if needed.

NEW: -- On Wednesday, Nov. 18 and Thursday, Nov. 19, the left lane of eastbound 550 is closed from the Wells Fargo Bank to NM 313 (Paseo Del Pueblo). On Thursday, Nov. 19 and Friday, Nov. 20, eastbound and westbound U.S. 550 will have the inside lane closed from west of the Rio Grande Bridge to Dimas Way. **Motorists should expect delays.**

REMINDER – On Wednesday, Nov. 18 and Thursday, Nov. 19, the left lane of eastbound U.S. 550 will be closed for approximately 200 feet west of the intersection of U.S. 550 and NM 313 (Camino Del Pueblo) so crews can complete some final work in the area.

**WORK
CONTINUING
ON NM 528:**

The inside lanes are closed on NM 528 from Carr Way south of the intersection of NM 528 and U.S. 550 to about 440 feet north on Tamaya Blvd. so crews can demolish existing median. These closures are expected to continue through late November.

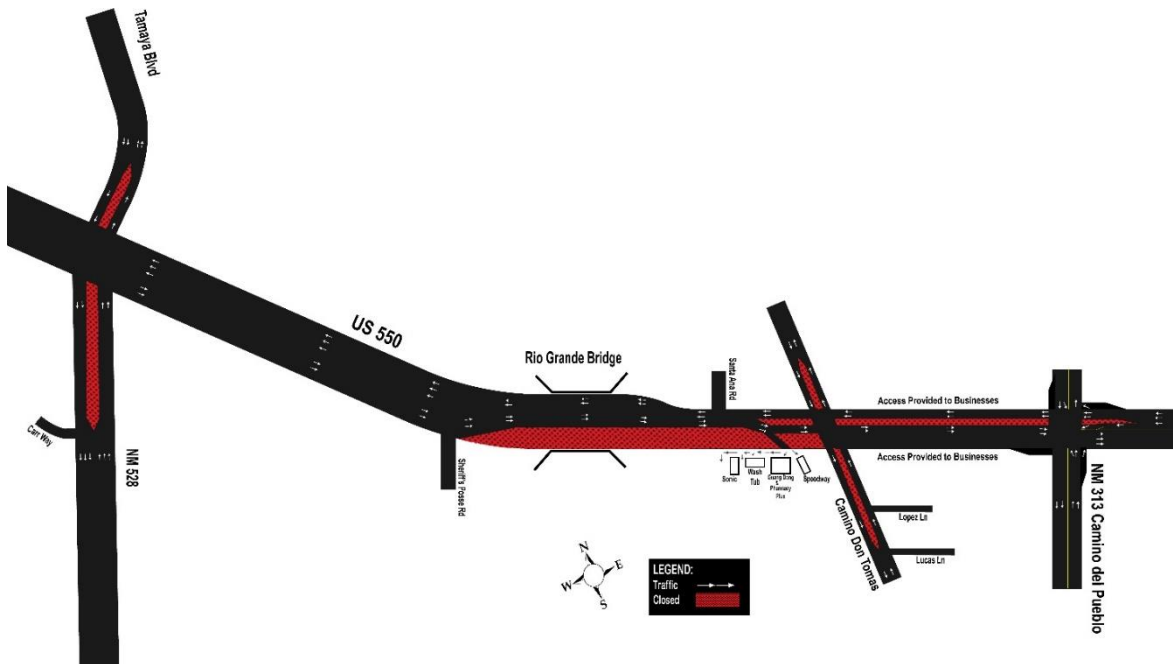

WORK CONTINUING ON U.S. 550: Eastbound traffic is shifted to the north for crews to pave a section of U.S. 550 west of Camino Don Tomas this week (weather permitting), with reopening of the roadway tentatively scheduled for late this week. Until the roadway reopens, access to some businesses is from eastbound U.S. 550 between Guang Dong Chinese Restaurant/Pharmacy Plus and Speedway, as shown on the map above.

MOTORISTS ARE ENCOURAGED TO EXPECT DELAYS AND TO GIVE THEMSELVES EXTRA TIME TO REACH THEIR DESTINATIONS. Questions, Concerns: Visit www.KeepMoving550.com or www.nmroads.com or contact Patti Watson – 505-245-3134, 505-269-9691, pattiw@cwastrategic.com.