



Construction Update: Week of Nov. 23-29, 2020

NOTE: All work is scheduled weather permitting, and is subject to change without notice.

REGULAR WORK HOURS: Monday-Friday 7 a.m.-5 p.m. although crews may work longer hours or weekends if needed. *Crews will be off on Thursday, Nov. 26 and Friday, Nov. 27 for the Thanksgiving Holiday, but barricades will remain in place for safety.*

NEW: -- Both eastbound and westbound U.S. 550 were open with two lanes of traffic in each direction as of Friday, Nov. 20, 2020. Also, Camino Don Tomas was open as of Friday, Nov. 20 in its final configuration with the exception of one closed left turn lane for northbound traffic and one closed left turn lane for southbound traffic for installation of lighting.

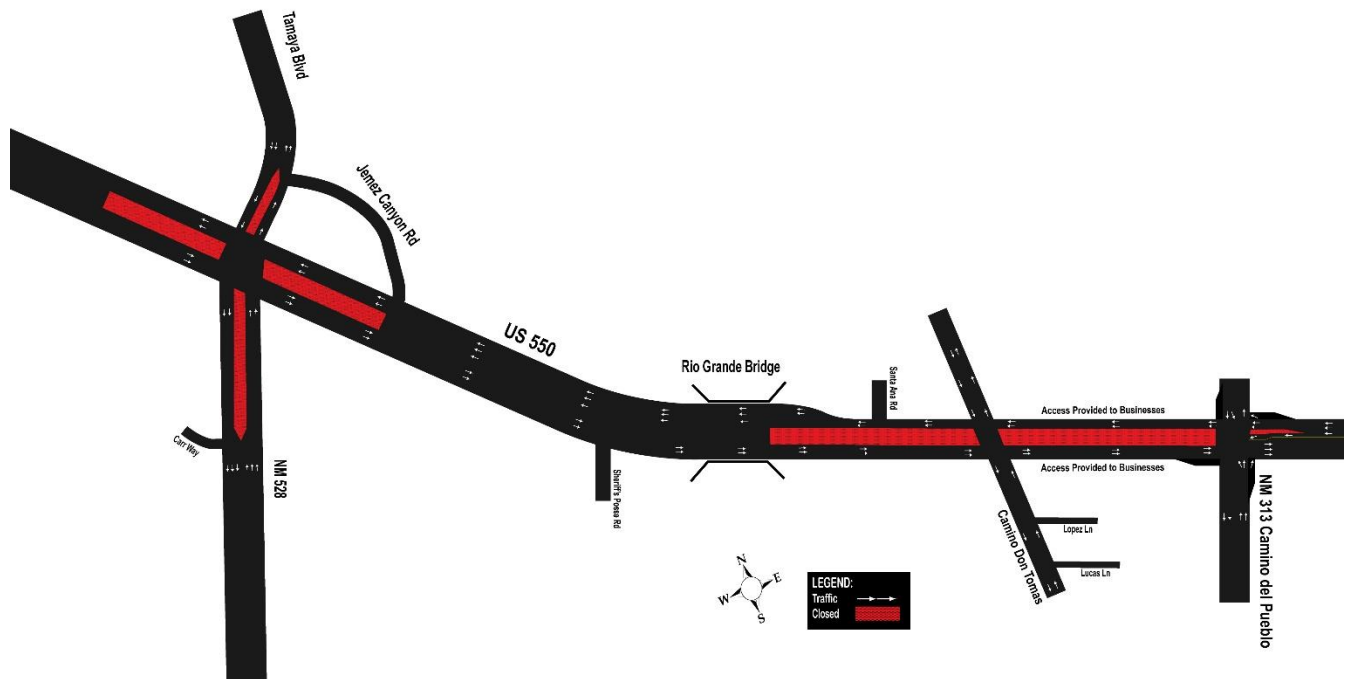

WORK CONTINUING ON NM 528: The inside lanes are closed on NM 528 from Carr Way south of the intersection of NM 528 and U.S. 550 to about 440 feet north on Tamaya Blvd. so crews can demolish existing median. These closures are expected to continue through late November.

WORK CONTINUING ON U.S. 550: Work is continuing in the center median portion of U.S. 550 from NM 313 (Camino Don Tomas) to the Rio Grande Bridge and from Jemez Canyon Dam Road to west of NM 528.

MOTORISTS ARE ENCOURAGED TO EXPECT DELAYS AND TO GIVE THEMSELVES EXTRA TIME TO REACH THEIR DESTINATIONS. Questions, Concerns: Visit www.keepmoving550.com or www.nmroads.com or contact Patti Watson – 505-245-3134, 505-269-9691, pattiw@cwstrategic.com.