



U.S. Department of Transportation
**Federal Highway
Administration**



Construction Update:
Week of Nov. 9-15, 2020

NOTE: All work is scheduled weather permitting, and is subject to change without notice.

REGULAR WORK HOURS: Monday-Friday 7 a.m.-5 p.m. although crews may work longer hours or weekends if needed.

CONTINUING: Crews are placing curb and colored concrete in the median on U.S. 550 from NM 313 (Camino Del Pueblo) to Camino Don Tomas. **Businesses will only have right-in and right-out access as this median is placed. Left turns will only be allowed in designated areas.**

Eastbound traffic will continue to be shifted to the north for crews to install subgrade, base course and curb and gutter in preparation for paving a section of U.S. 550 west of Camino Don Tomas and reopening the roadway in mid to late November, 2020. Access to some businesses will be from eastbound U.S. 550 between Guang Dong Chinese Restaurant/Pharmacy Plus and Speedway, as shown on the map below.

Crews are installing aggregate base course on U.S.550 from Camino Don Tomas to the Rio Grande Bridge and placing curb and colored concrete on U.S. 550 west of Camino Don Tomas. They are also finishing up work in front of some businesses on the south side of U.S. 550.

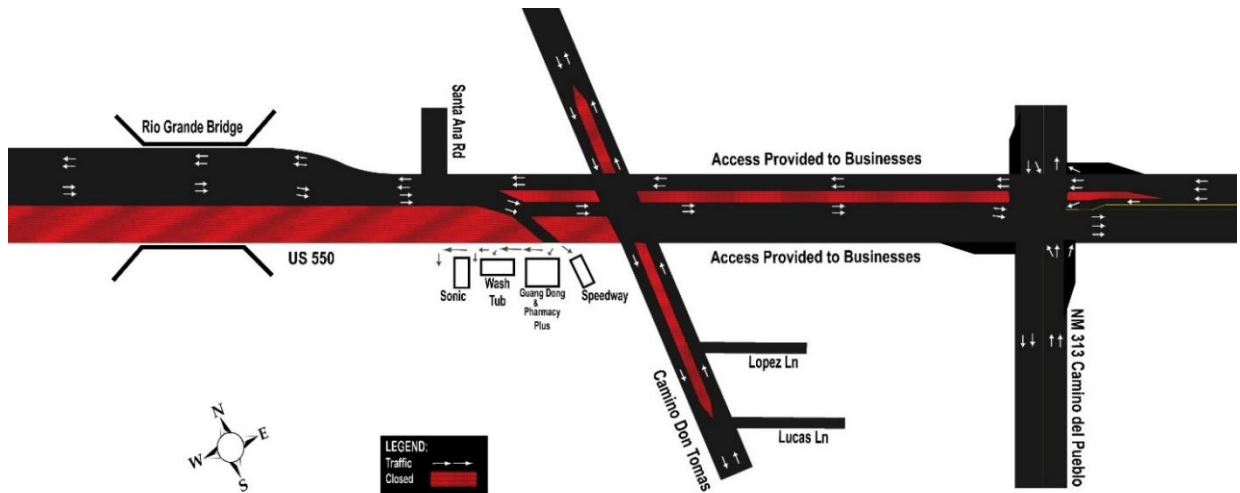

NOTE: Construction is tentatively scheduled to move to the west side of the Rio Grande in mid-December 2020.

Two travel lanes in each direction (east and west) are provided on U.S. 550 and there is **no center left turn lane. Left turns are only permitted at intersections with traffic signals.** Camino Don Tomas is open with one lane of traffic in each direction (north and south) north and south of U.S. 550.

MOTORISTS ARE ENCOURAGED TO EXPECT DELAYS AND TO GIVE THEMSELVES EXTRA TIME TO REACH THEIR DESTINATIONS.

Questions, Concerns: Visit www.KeepMoving550.com or www.nmroads.com or contact Patti Watson – 505-245-3134, 505-269-9691, pattiw@cwstrategic.com.