



U.S. Department of Transportation
**Federal Highway
Administration**



Construction Update: Week of Dec. 21-27, 2020

NOTE: All work is scheduled weather permitting, and is subject to change without notice.

REGULAR WORK HOURS: Monday-Friday 7 a.m.-5 p.m. although crews may work longer hours or weekends if needed. Crews will not be working Thursday, Dec. 24 or Friday, Dec. 25 in observance of the Christmas holiday, but barricades will remain in place for safety.

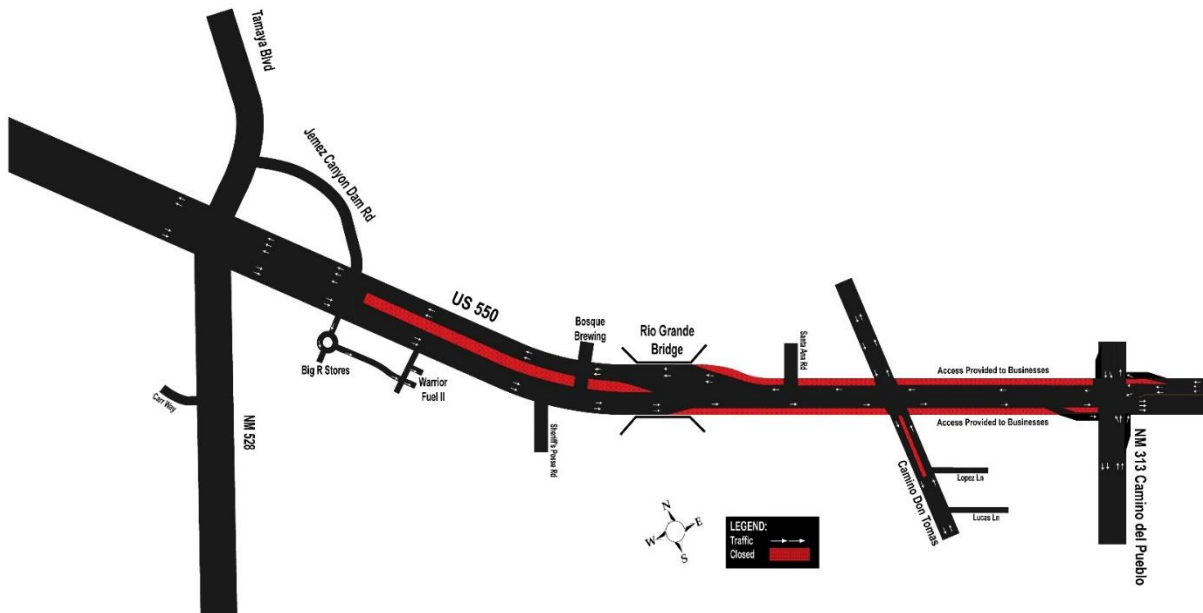

NEW: Crews will be modifying access to Lopez Lane from Camino Don Tomas. During this work, the center lane of Camino Don Tomas will be closed from south of U.S. 550 to south of Lopez Lane. **Also, the outside lanes of both eastbound and westbound U.S. 550 will be closed from NM 313 (Camino del Pueblo) to the Rio Grande Bridge so that crews can make repairs to curb and gutter and sidewalk. Two lanes of traffic will be open in each direction (eastbound and westbound).** In addition, there will be **NO ACCESS** from U.S. 550 to Twin Warrior Fuel II. **Access will be from the Big R Stores on U.S. 550.**

CONTINUING: Crews are laying a large storm drainage pipe in the center of U.S. 550 from the Rio Grande Bridge heading west. The traffic signal at Sheriff's Posse Road has been removed, and there are NO left turns from U.S. 550 to Sheriff's Posse Road. Motorists can utilize the traffic signal at Bosque Brewing or Jemez Canyon Dam Road for U-turns. *NOTE: Crews are working on a plan for a detour to restore left-turn access to Sheriff's Posse Road, which is tentatively scheduled for mid-January.*

MOTORISTS ARE ENCOURAGED TO EXPECT DELAYS AND TO GIVE THEMSELVES EXTRA TIME TO REACH THEIR DESTINATIONS.

Questions, Concerns: Visit www.keepmoving550.com or www.nmroads.com or contact Patti Watson – 505-245-3134, 505-269-9691, pattiw@cwstrategic.com.