



U.S. Department of Transportation
**Federal Highway
Administration**



Construction Update: Week of March 8-14, 2021

NOTE: All work is scheduled weather permitting, and is subject to change without notice.

REGULAR WORK HOURS: Monday-Friday 7 a.m.-5 p.m. although crews may work longer hours or weekends if needed.

NEW: Crews will extend installation of a large storm drainage pipe in the center median of U.S. 550 to west of Jemez Canyon Dam Road beginning Monday, March 8, 2021.

Westbound motorists will be able to turn right on Jemez Canyon Dam Road, but there will be no U-turns at this intersection for several weeks. *Motorists can continue to use the traffic signal near Bosque Brewing for U-turns.*

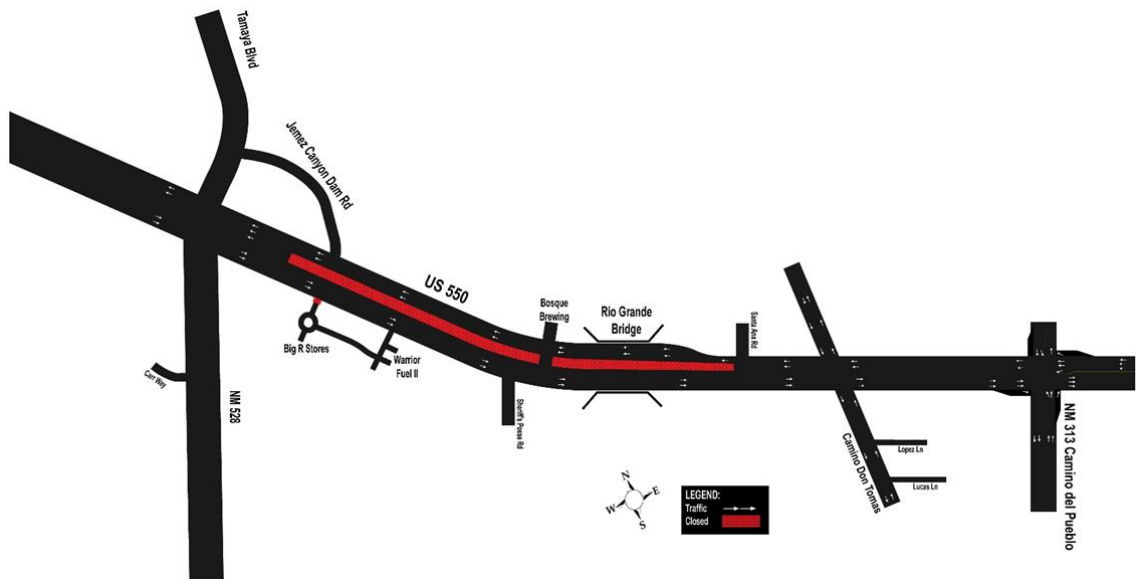

Also, the left (outside) lane of eastbound U.S. 550 is scheduled to be closed from 9 a.m.-3 p.m. Tuesday, March 9 between the Rio Grande Bridge and Camino Don Tomas for manhole work. *Motorists traveling in this area during this time should expect delays.*

CONTINUING: Weather permitting, the entrance to Big R Stores is expected to be paved and reopened this week. Until the entrance is opened, access to Big R Stores is from Warrior Fuel II. **The inside lane of westbound U.S. 550 is closed from Santa Ana Road to west of Jemez Canyon Dam Road.** Also, there are occasional right lane closures on westbound U.S. 550 from the Rio Grande Bridge to west of Jemez Canyon Dam Road. Crews are laying a large storm drainage pipe in the center of U.S. 550 from the Rio Grande Bridge heading west. The traffic signal at Sheriff's Posse Road has been removed, and there are NO left turns from U.S. 550 to Sheriff's Posse Road. Motorists can utilize the traffic signal at Bosque Brewing or Jemez Canyon Dam Road for U-turns. *NOTE: The detour to restore left-turn access to Sheriff's Posse Road is expected to be open by the end of March 2021. **MOTORISTS ARE ENCOURAGED TO EXPECT DELAYS AND TO GIVE THEMSELVES EXTRA TIME TO REACH THEIR DESTINATIONS.***

Questions, Concerns: Visit www.keepmoving550.com or www.nmroads.com or contact Patti Watson – 505-245-3134, 505-269-9691, pattiw@cwastateqic.com.