



U.S. Department of Transportation
**Federal Highway
Administration**



Construction Update: Crews to Begin Work on Tamaya Blvd and NM 528 Thursday, May 27, 2021

NOTE: All work is scheduled weather permitting and is subject to change without notice.

REGULAR WORK HOURS: Monday-Friday, 7 a.m.-5 p.m., although crews may work longer hours or weekends if needed. *NOTE: Crews will not be working Monday, May 31, in observance of the Memorial Day holiday, but barricades will remain in place for safety.*

NEW: In addition to the work on U.S. 550, crews will **begin construction on Tamaya Blvd and NM 528 Thursday, May 27.** Traffic on Tamaya Blvd will be shifted to the east just north of U.S. 550, with one combination thru lane/right lane and one dedicated left turn lane open southbound and one lane open northbound.

Traffic on NM 528 will also be shifted to the east, with two lanes available in each direction (northbound and southbound).

ONGOING: Westbound traffic on U.S. 550 is shifted to the south from Jemez Canyon Dam Rd to west of Tamaya Blvd. **NOTE: There is only one turn lane for westbound traffic on U.S. 550 to turn left to access southbound NM 528.**

Westbound U.S. 550 motorists turning left to head south on NM 528 should expect delays and give themselves extra time.

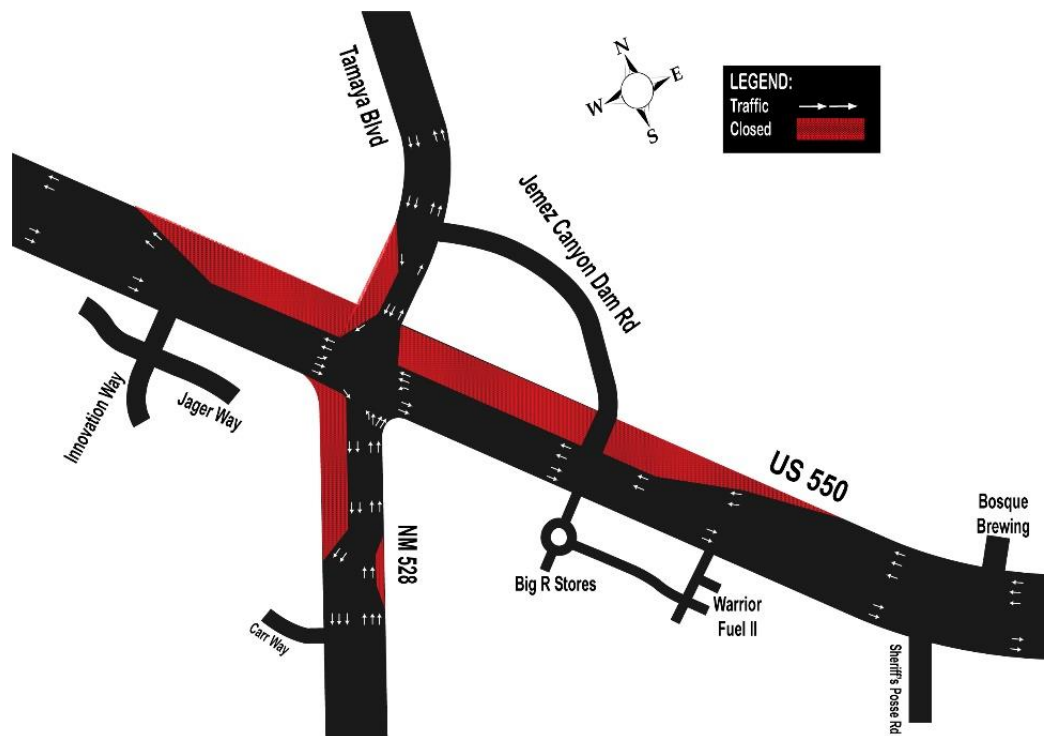

Westbound motorists are still able to turn right on Jemez Canyon Dam Rd, but there are no U-turns and no left turns at this intersection. Motorists can access the U-turn at Bosque Brewing. The left turn at Sheriff's Posse Rd is open, but crews may occasionally have to block access to this turn for work at the intersection. We anticipate installing the traffic signal at this intersection this week or next week. *Motorists turning left on Sheriff's Posse Rd should yield to oncoming eastbound traffic on U.S. 550.*

MOTORISTS ARE ENCOURAGED TO EXPECT DELAYS AND TO GIVE THEMSELVES EXTRA TIME TO REACH THEIR DESTINATIONS.

Questions, Concerns: Visit www.keepmoving550.com or www.nmroads.com or contact Patti Watson – 505-245-3134, 505-269-9691, pattiw@cwastrategic.com.