



U.S. Department of Transportation
**Federal Highway
Administration**



Construction Update: Week of June 28-July 4, 2021

NOTE: All work is scheduled weather permitting and is subject to change without notice.

REGULAR WORK HOURS: Monday-Friday, 6 a.m.-4 p.m., although crews may work longer hours or weekends if needed. *Crews will not be working on Monday, July 5, in observance of the Fourth of July holiday.*

NEW – IMPORTANT: Jemez Canyon Dam Road will be closed at U.S. 550 on Monday, June 28, and Tuesday, June 29, with no right-turn-in or right-turn-out access so crews can prepare the road for eventual paving.

ONGOING: Traffic on Tamaya Blvd is shifted to the east just north of U.S. 550, with one combination thru lane/right lane and one dedicated turn lane open southbound and one lane open northbound.

Traffic on NM 528 is also shifted to the east, with two lanes available in each direction (northbound and southbound).

Westbound traffic on U.S. 550 is shifted to the south from Jemez Canyon Dam Rd to west of Tamaya Blvd.

NOTE: There is only one turn lane for westbound traffic on U.S. 550 to turn left to access southbound NM 528.

Westbound U.S. 550 motorists turning left to head south on NM 528 should expect delays and give themselves extra time.

Westbound motorists are still able to turn right on Jemez Canyon Dam Rd, but there are no U-turns and no left turns at this intersection. Motorists can access the U-turn at Bosque Brewing.

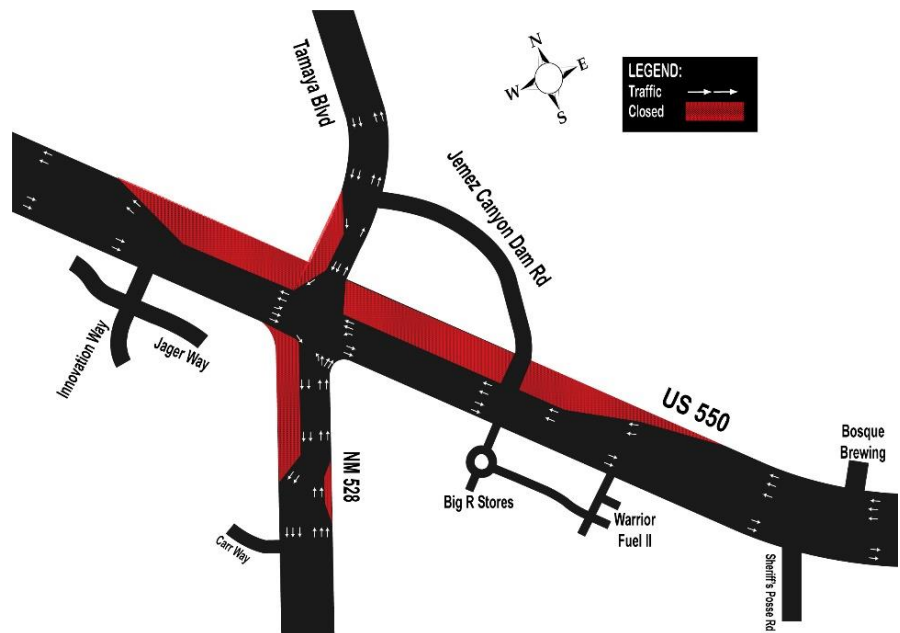

MOTORISTS ARE ENCOURAGED TO EXPECT DELAYS AND TO GIVE THEMSELVES EXTRA TIME TO REACH THEIR DESTINATIONS.

For real-time traffic cameras on the U.S. 550 project, visit <http://us550.rtsclients.com/>

Questions, Concerns: Visit www.KeepMoving550.com or www.nmroads.com or contact Patti Watson – 505-245-3134, 505-269-9691, pattiw@cwastategic.com.