



U.S. Department of Transportation  
**Federal Highway  
 Administration**



**IMPORTANT:** Traffic to Shift to Northbound Lanes of U.S. 550 Friday, July 16; Construction Update for Week of July 19-25, 2021

*NOTE: All work is scheduled weather permitting and is subject to change without notice.*

**REGULAR WORK HOURS:** Monday-Friday, 6 a.m.-4 p.m., although crews may work longer hours or weekends if needed.

**NEW:** On Friday, July 16, traffic will shift to the north on both eastbound and westbound U.S. 550, with two lanes of traffic open in each direction.

Also, crews will shift to the east side (northbound lanes) of NM 528 and Tamaya Blvd to begin construction on the Continuous Flow Interchange (CFI) at the intersection of NM 528 and U.S. 550 (for info on how the CFI will work, visit <https://keepmoving550.com/>).

Northbound traffic on Tamaya Blvd will be restricted to one lane just north of U.S. 550 and southbound traffic on NM 528 will be restricted to just one lane of traffic just south of U.S. 550. **Westbound U.S. 550 motorists turning left to head south on NM 528 should continue to expect delays and give themselves extra time.**

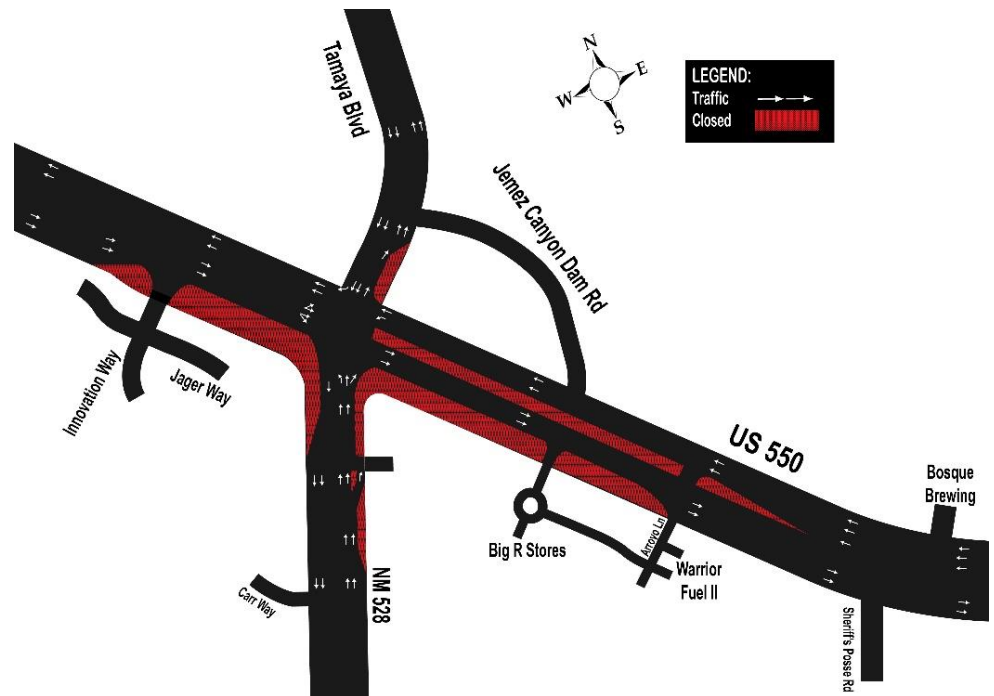

Crews anticipate having the traffic signal at Warrior Fuel II and the Santa Ana Casino operational on July 19, 2021.

*NOTE: Crews will be working on islands and medians in the center of U.S. 550 in order to accommodate the CFI. There will be occasional lane restrictions for this work on both eastbound and westbound U.S. 550. Motorists should expect delays and give themselves extra time to reach their destinations.*

For real-time traffic cameras on the U.S. 550 project, visit <http://us550.rtsclients.com/>

Questions, Concerns: Visit [www.keepmoving550.com](http://www.keepmoving550.com) or [www.nmroads.com](http://www.nmroads.com) or contact Patti Watson – 505-245-3134, 505-269-9691, [pattiw@cwastategic.com](mailto:pattiw@cwastategic.com).