



U.S. Department of Transportation  
**Federal Highway  
Administration**



## Construction Update: Week of September 13-19, 2021

*NOTE: All work is scheduled weather permitting and is subject to change without notice.*

**REGULAR WORK HOURS:** Monday-Friday, 6 a.m.-4 p.m., although crews may work longer hours or weekends if needed.

**ONGOING:** Eastbound traffic on U.S. 550 has been shifted to the north so crews can work in the far right-hand lane. **Two lanes of traffic are open.**

The two westbound lanes on U.S. 550 will remain in their current configuration.

Northbound NM 528 south of U.S. 550 has shifted to the east, with a right-turn lane to access eastbound U.S. 550 and a thru lane.

Crews are continuing work on the Continuous Flow Interchange (CFI) at the intersection of NM 528 and U.S. 550 (for info on how the CFI will work, visit <https://keepmoving550.com/>).

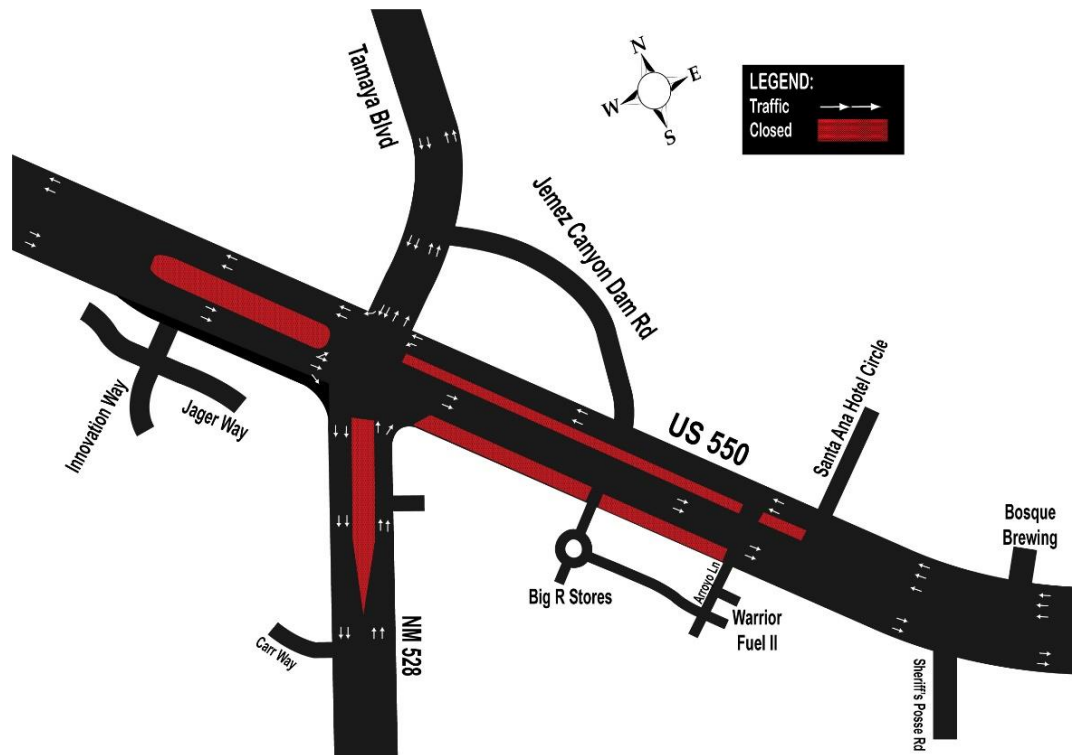

**Westbound U.S. 550: Motorists turning left to head south on NM 528 should continue to expect delays and give themselves extra time. The left-hand lane is for thru traffic as well as traffic turning left to head south on NM 528.**

**NOTE: There will be occasional lane restrictions on both eastbound and westbound U.S. 550 for work in the medians and on the CFI. Motorists should expect delays and give themselves extra time to reach their destinations.**

For real-time traffic cameras on the U.S. 550 project, visit <http://us550.rtsclients.com/>

**Questions, Concerns: Visit [www.keepmoving550.com](http://www.keepmoving550.com) or [www.nmroads.com](http://www.nmroads.com) or contact Patti Watson – 505-245-3134, 505-269-9691, [pattiw@cwastateqic.com](mailto:pattiw@cwastateqic.com).**