



U.S. Department of Transportation
**Federal Highway
Administration**



Construction Update: Week of Oct. 11-17, 2021

NOTE: All work is scheduled weather permitting and is subject to change without notice.

REGULAR WORK HOURS: Monday-Friday, 6 a.m.-4 p.m., although crews may work longer hours or weekends if needed.

ONGOING: Crews will continue paving various portions of both eastbound and westbound U.S. 550 this week. *Motorists should expect lane closures and delays, and give themselves extra time to reach their destinations.*

Crews will continue grinding asphalt paving this week from 9 p.m. each evening to 5 a.m. the following morning. There will be single-lane closures on eastbound and westbound U.S. 550. Crews will work in one direction at a time. At least one lane will remain open in the direction crews are grinding, but *motorists should expect delays.*

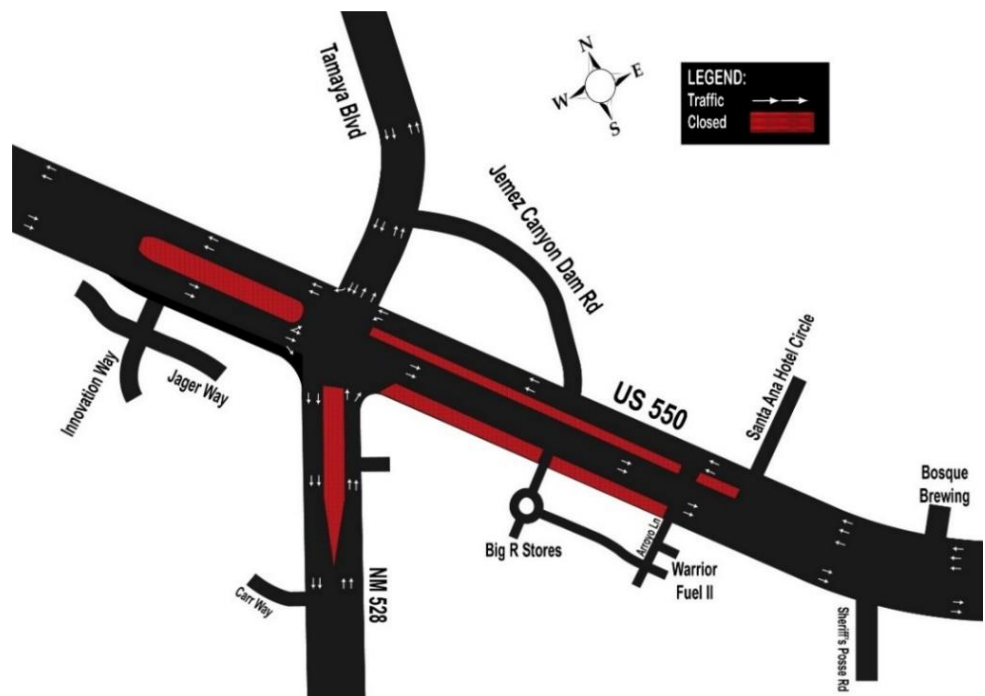

Eastbound traffic on U.S. 550 has been shifted to the north so crews can work in the far right-hand lane. Traffic on westbound lanes on U.S. 550 will remain in their current configuration.

Northbound traffic on NM 528 south of U.S. 550 has shifted to the east, with a right-turn lane to access eastbound U.S. 550 and a thru lane. Crews are continuing work on the Continuous Flow Interchange (CFI) at the intersection of NM 528 and U.S. 550 (*for info on how the CFI will work, visit <https://keepmoving550.com/>*).

Westbound U.S. 550: *Motorists turning left to head south on NM 528 should continue to expect delays and give themselves extra time. The left-hand lane is for thru traffic as well as traffic turning left to head south on NM 528.*

For real-time traffic cameras on the U.S. 550 project, visit <http://us550.rtsclients.com/>

Questions, Concerns: Visit www.keepmoving550.com or www.nmroads.com or contact Patti Watson – 505-245-3134, 505-269-9691, pattiw@cwastateqic.com.