



U.S. Department of Transportation
**Federal Highway
 Administration**



**Construction Update:
 Week of Nov. 1-7, 2021**

NOTE: All work is scheduled weather permitting and is subject to change without notice.

REGULAR WORK HOURS: Monday-Friday, 6 a.m.-4 p.m., although crews may work longer hours or weekends if needed.

NEW: Crews will be installing striping and concrete on both eastbound and westbound U.S. 550 from the Rio Grande Bridge to NM 528.

There will be short-duration lane reductions on both eastbound and westbound U.S. 550 for this work.

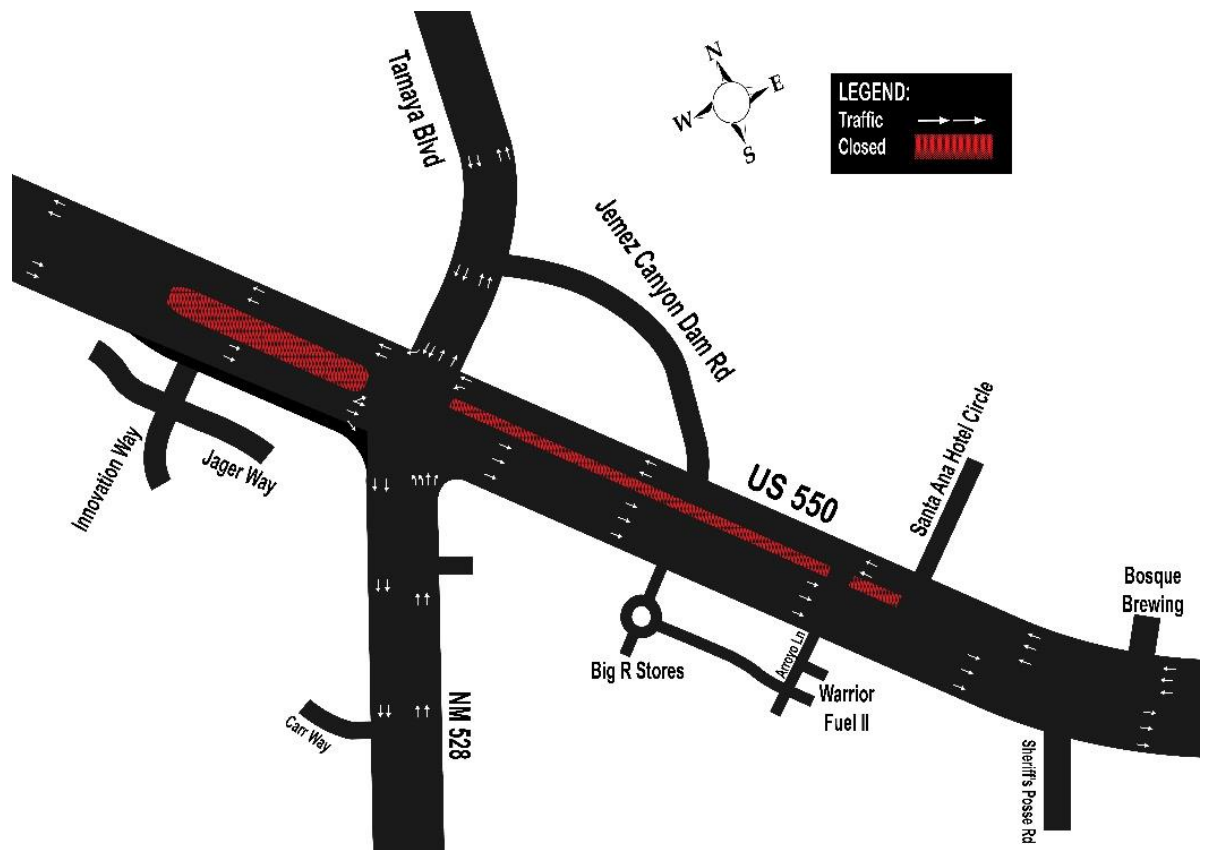

MOTORISTS SHOULD EXPECT DELAYS AND GIVE THEMSELVES EXTRA TIME TO REACH THEIR DESTINATION.

Westbound U.S. 550: Motorists turning left to head south on NM 528 should continue to expect delays and give themselves extra time. The left-hand lane is for thru traffic as well as traffic turning left to head south on NM 528.

For real-time traffic cameras on the U.S. 550 project, visit <http://us550.rtsclients.com/>.

Questions, Concerns: Visit www.KeepMoving550.com or www.nmroads.com or contact Patti Watson – 505-245-3134, 505-269-9691, pattiw@cwstrategic.com.